

NPN Silicon Epitaxial Planar Transistor

Medium Power High Performance Transistor

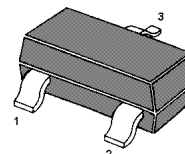

1.Base 2.Emitter 3.Collector
SOT-23 Plastic Package

Absolute Maximum Ratings ($T_a = 25^\circ\text{C}$)

Parameter	Symbol	Value	Unit
Collector Base Voltage	V_{CBO}	170	V
Collector Emitter Voltage	V_{CEO}	150	V
Emitter Base Voltage	V_{EBO}	5	V
Collector Current	I_C	1	A
Peak Pulse Current	I_{CM}	2	A
Power Dissipation	P_{tot}	200	mW
Junction Temperature	T_j	150	$^\circ\text{C}$
Storage Temperature Range	T_{stg}	- 55 to + 150	$^\circ\text{C}$

Characteristics at $T_a = 25^\circ\text{C}$

Parameter	Symbol	Min.	Max.	Unit
DC Current Gain				
at $V_{CE} = 10\text{ V}$, $I_C = 1\text{ mA}$	h_{FE}	100	-	-
at $V_{CE} = 10\text{ V}$, $I_C = 250\text{ mA}$	h_{FE}	100	300	-
at $V_{CE} = 10\text{ V}$, $I_C = 500\text{ mA}$	h_{FE}	50	-	-
at $V_{CE} = 10\text{ V}$, $I_C = 1\text{ A}$	h_{FE}	10	-	-
Collector Base Cutoff Current				
at $V_{CB} = 150\text{ V}$	I_{CBO}	-	100	nA
Collector Emitter Cutoff Current				
at $V_{CE} = 150\text{ V}$	I_{CES}	-	100	nA
Emitter Base Cutoff Current				
at $V_{EB} = 4\text{ V}$	I_{EBO}	-	100	nA
Collector Base Breakdown Voltage				
at $I_C = 100\text{ }\mu\text{A}$	$V_{(BR)CBO}$	170	-	V
Collector Emitter Breakdown Voltage				
at $I_C = 10\text{ mA}$	$V_{(BR)CEO}$	150	-	V
Emitter Base Breakdown Voltage				
at $I_E = 100\text{ }\mu\text{A}$	$V_{(BR)EBO}$	5	-	V
Collector Emitter Saturation Voltage				
at $I_C = 250\text{ mA}$, $I_B = 25\text{ mA}$	V_{CEsat}	-	0.2	V
at $I_C = 500\text{ mA}$, $I_B = 50\text{ mA}$	V_{CEsat}	-	0.3	V
Base Emitter Saturation Voltage				
at $I_C = 500\text{ mA}$, $I_B = 50\text{ mA}$	V_{BEsat}	-	1	V
Base Emitter On Voltage				
at $V_{CE} = 10\text{ V}$, $I_C = 500\text{ mA}$	$V_{BE(on)}$	-	1	V
Transition Frequency				
at $V_{CE} = 10\text{ V}$, $I_C = 50\text{ mA}$, $f = 100\text{ MHz}$	f_T	100	-	MHz
Collector Output Capacitance				
at $V_{CB} = 10\text{ V}$, $f = 1\text{ MHz}$	C_{ob}	-	10	pF

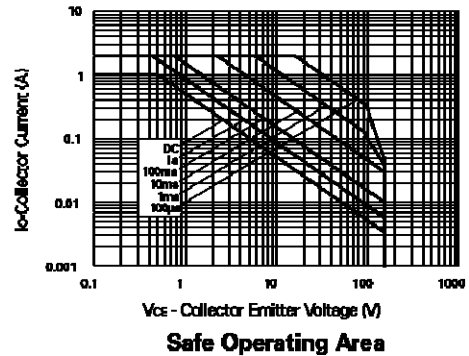
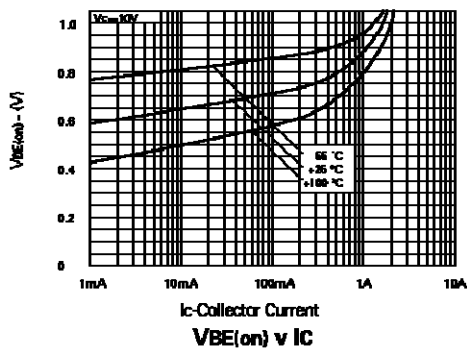
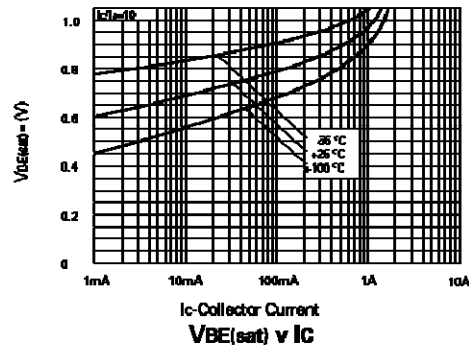
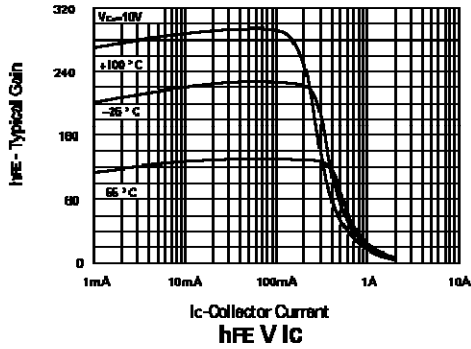
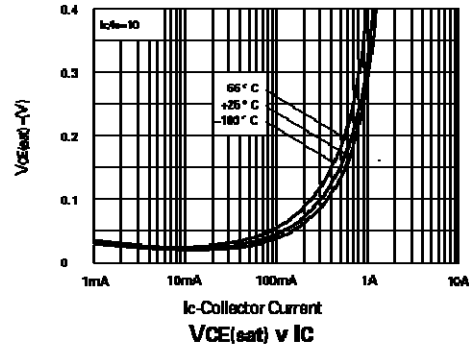
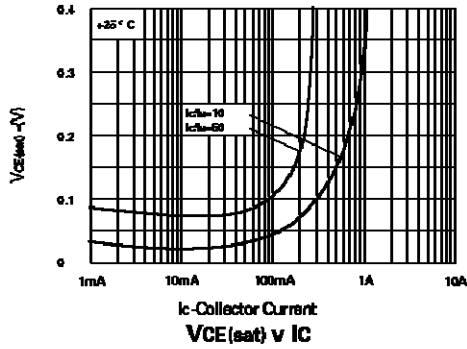



PACKAGE OUTLINE

Plastic surface mounted package; 3 leads

SOT-23

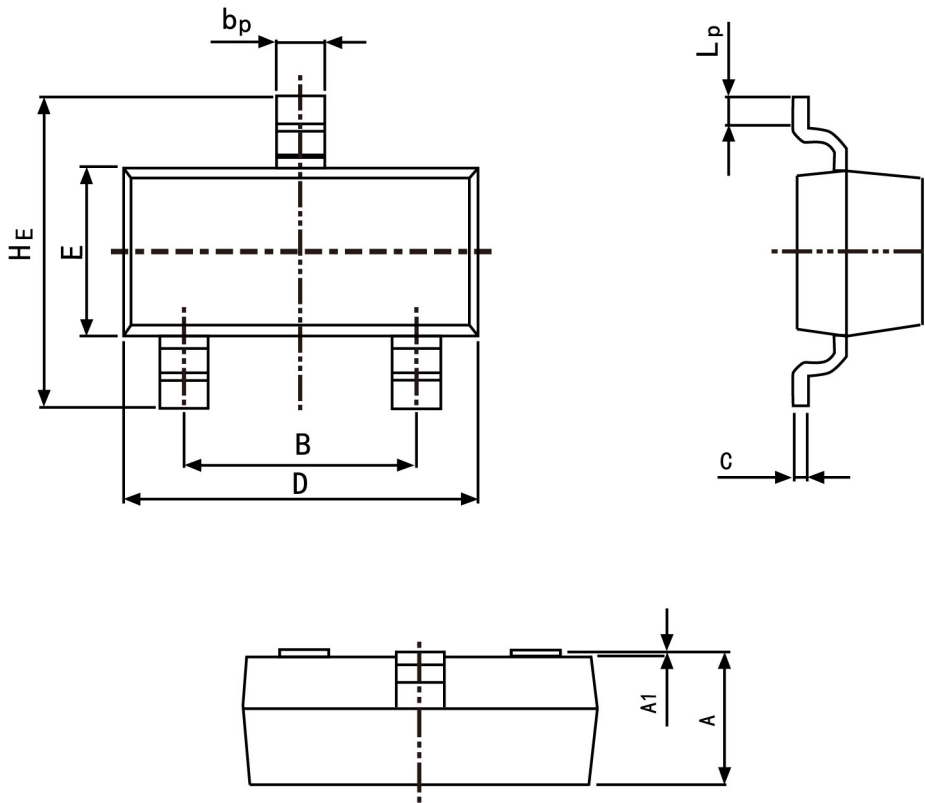

Symbol	Dimension in Millimeters	
	Min	Max
A	0.95	1.40
B	1.78	2.04
bp	0.35	0.50
C	0.08	0.19
D	2.70	3.10
E	1.20	1.65
HE	2.20	3.00
A1	0.100	0.013
Lp	0.20	0.50